

# INSTALLATION INSTRUCTIONS DVCT30 & DVCT35 LINER KITS

| BLACK REFLECTIVE LINERS |             |                         |
|-------------------------|-------------|-------------------------|
| DVCT30CBN               | DVCT35CBN   | Description             |
| DVP30CPKR-2             | DVP35CPKR-2 | Black Reflective Liners |

**LEAVE INSTRUCTIONS WITH THE HOMEOWNER.**

| CARTON CONTENTS  |                         |                      |                                  |
|------------------|-------------------------|----------------------|----------------------------------|
| Description      | Black Reflective Liners | Description (Cont'd) | Black Reflective Liners (Cont'd) |
| Rear Liner       | 1                       | Left Heat Shield     | 1                                |
| Left Liner       | 1                       | Liner Bracket, Side  | 2                                |
| Right Liner      | 1                       | Liner Bracket, Top   | 1                                |
| Bottom Liner     | 1                       | Rear Liner Bracket   | 1                                |
| Top Liner        | 1                       | #10 x 1/2 Screw      | 3                                |
| Rear Heat Shield | 1                       | #8 x 1/2 Screw       | 12                               |

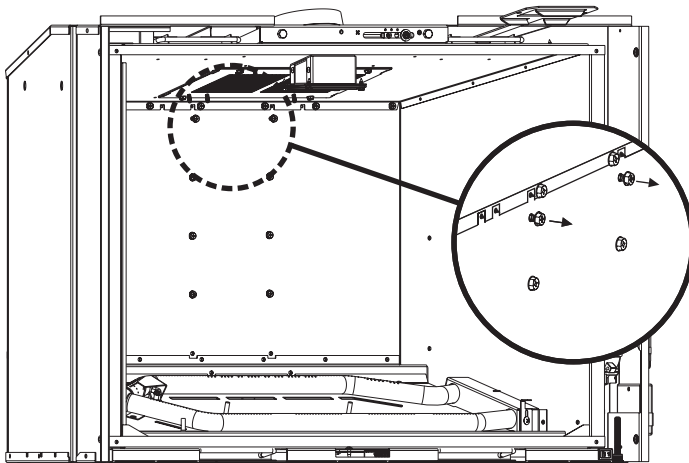
**TOOLS NEEDED:** Phillips Screwdriver

## REFLECTIVE LINER INSTALLATION

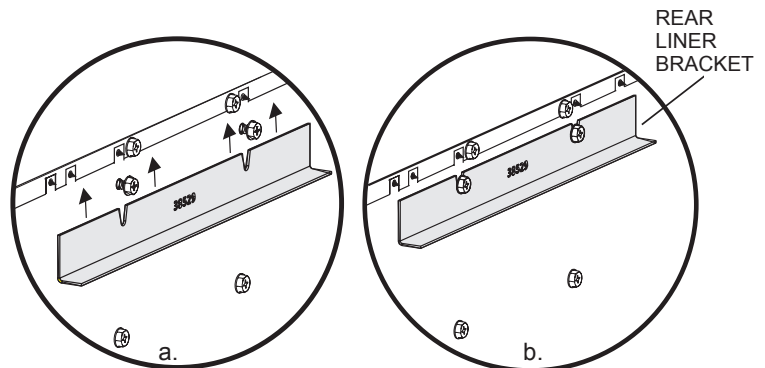
### **NOTICE: Before You Begin**

The glass panels are smooth on one side and textured on the other. Install liners with smooth side facing burners.

1. Remove barrier screen and glass door. Remove log set and existing liner kit if applicable. Store each in a safe location.
2. Loosen screws indicated. **See Figure 1.**
3. Slide rear liner bracket up under screw heads as shown in **Figure 2 a, b.** Hold rear liner bracket and tighten screws using screwdriver. (Do not use socket driver.)

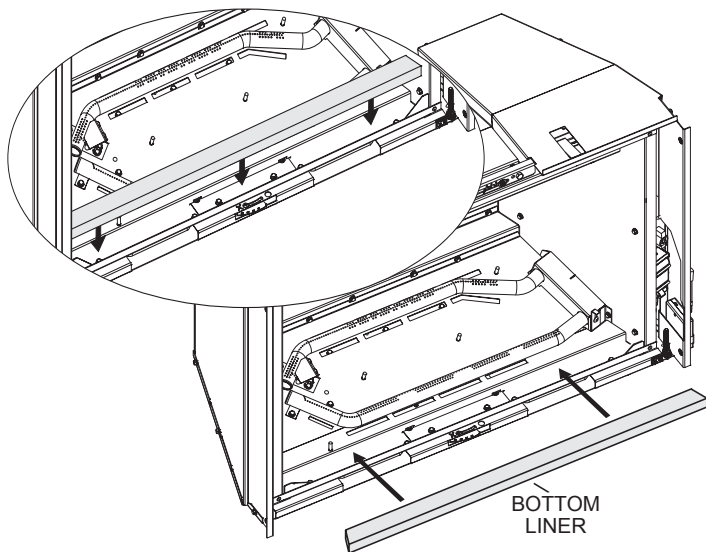


**Figure 1**



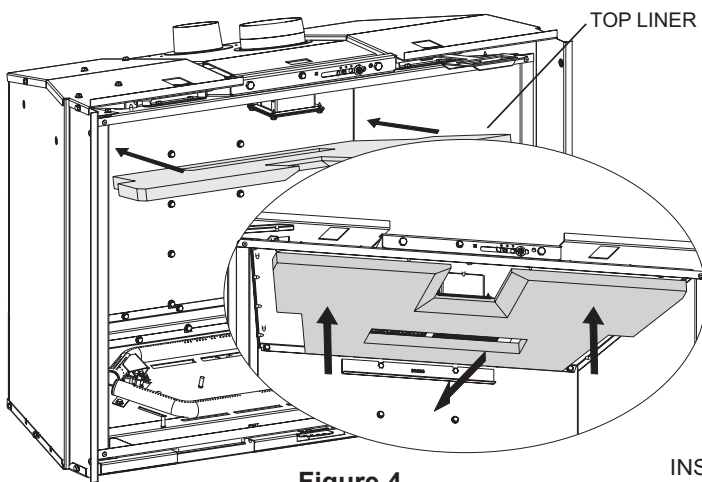
**Figure 2**

4. Place bottom liner as shown. **See Figure 3.**



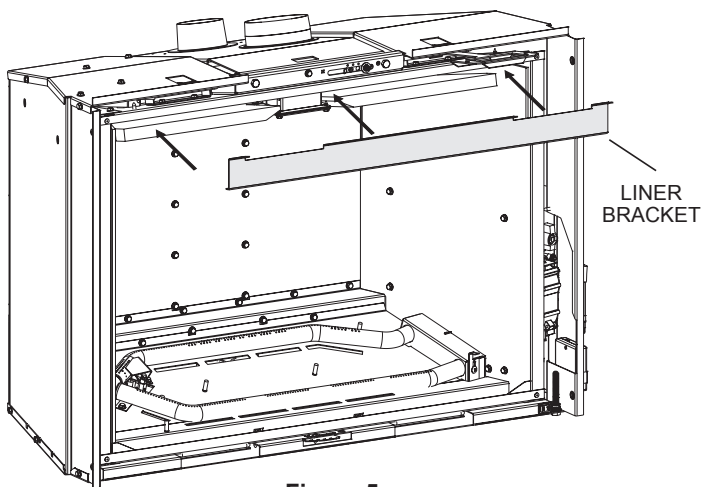
**Figure 3**

5. Place top ceramic fiber top liner above rear liner bracket with smooth side down. Position ceramic fiber top liner around light. Hold liner in place. **See Figure 4.**

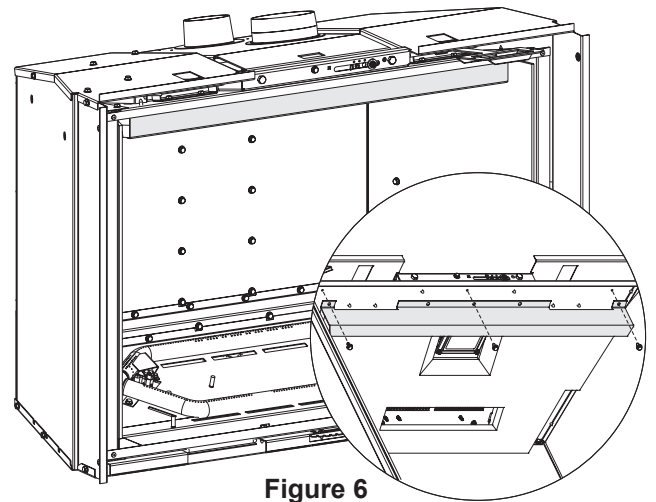


**Figure 4**

6. While holding ceramic fiber top liner, place liner bracket in position as shown. Insert three screws where shown. **See Figures 5 and 6.**

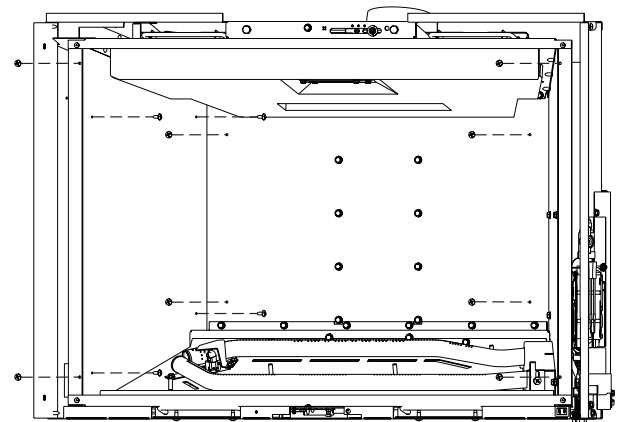


**Figure 5**



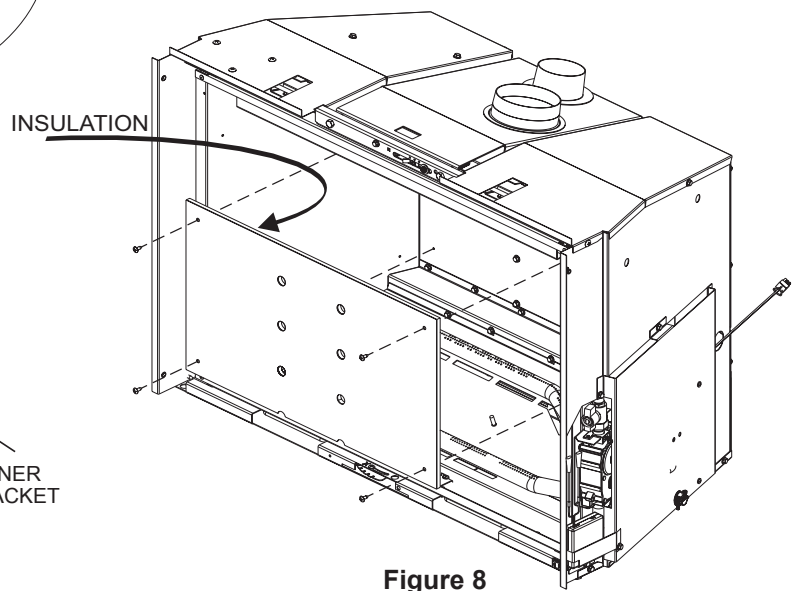
**Figure 6**

7. Remove 12 screws.



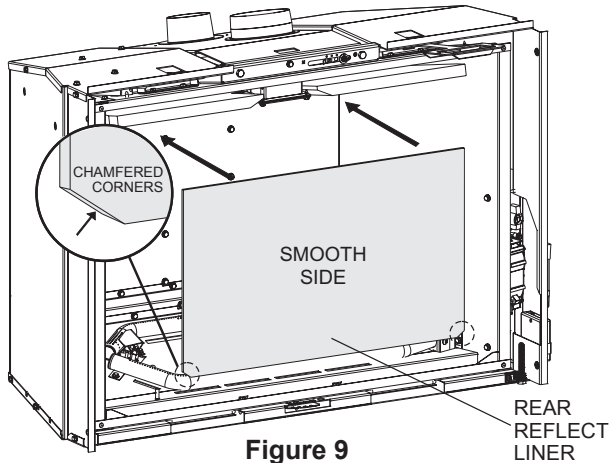
**Figure 7**

8. Install rear heat shield.



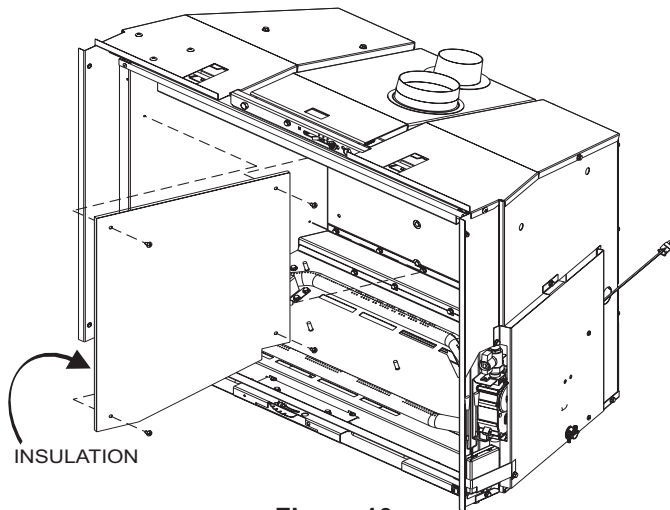
**Figure 8**

9. Center rear liner along rear wall with smooth side forward. Angle top of liner against rear wall with chamfered corners toward the bottom. **See Figure 9.**



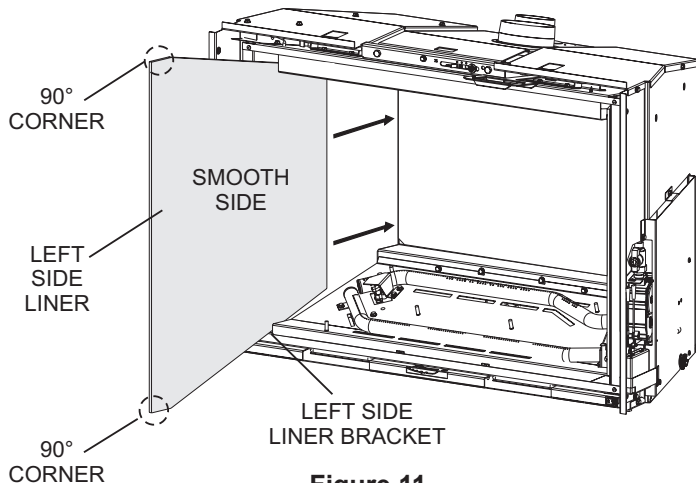
**Figure 9**

10. Install left heat shield.



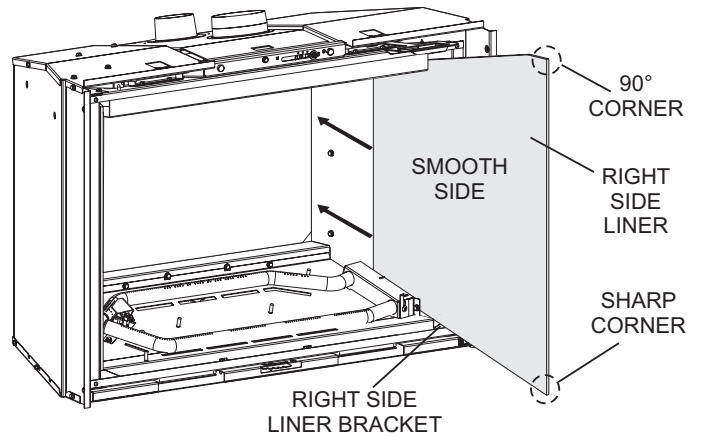
**Figure 10**

11. Verify the glass is oriented correctly as shown in **Figure 11**. Both front corners are at 90° angles. Slide left-side of liner along left side of firebox as shown with smooth surface toward the burners. Liner must go over or around left side liner bracket. When liner has passed the left side liner bracket, lower liner and slide forward until it rests behind the bracket. **See Figure 11.**



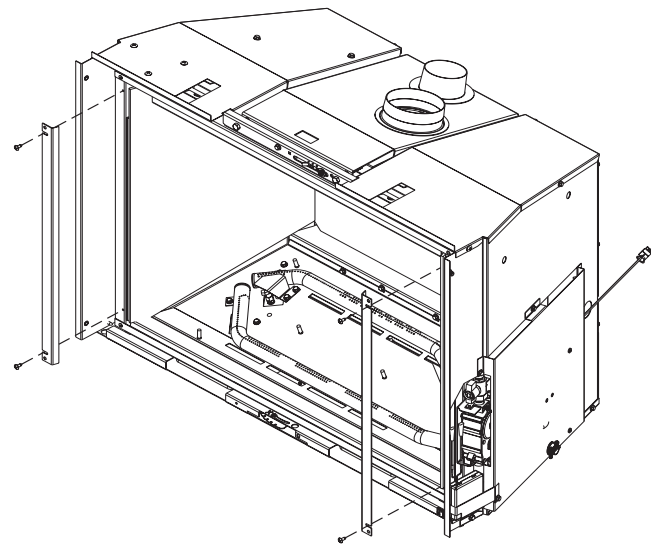
**Figure 11**

12. Repeat step 10 for right side assembly. **See Figure 11.**



**Figure 12**

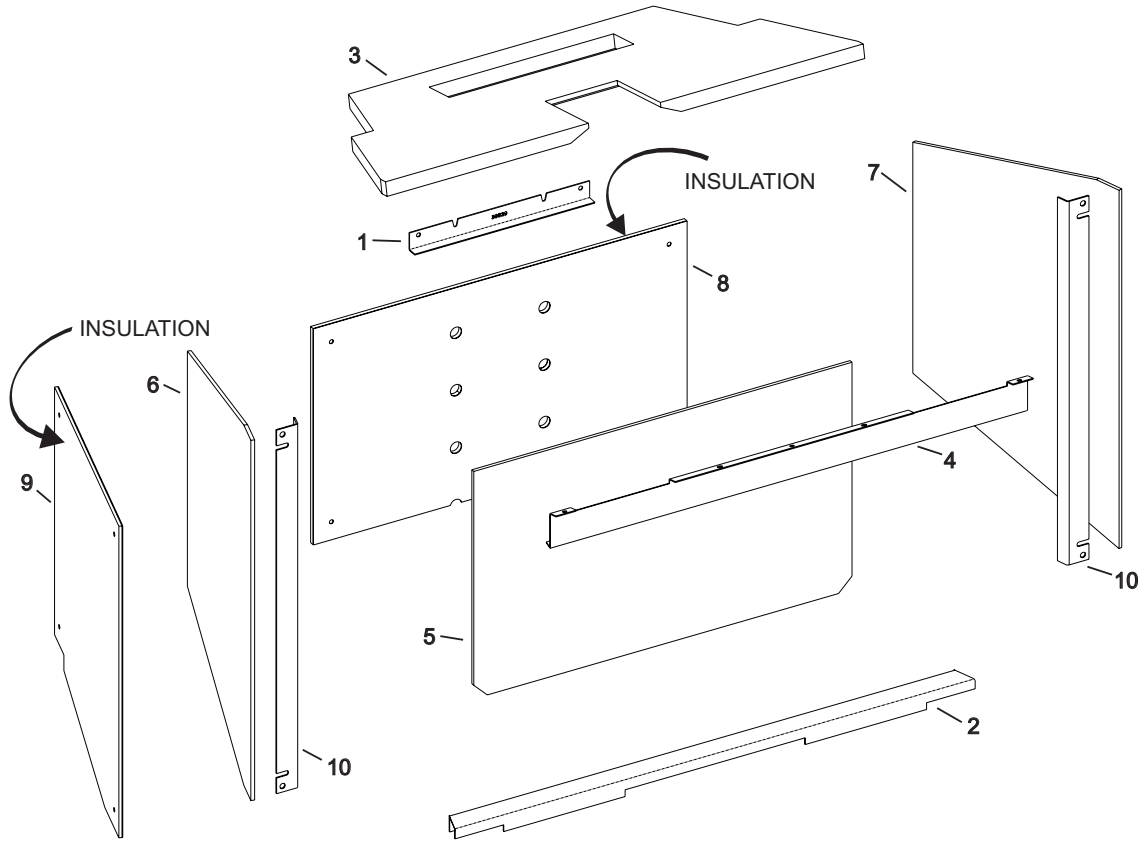
13. Install side liner bracket.



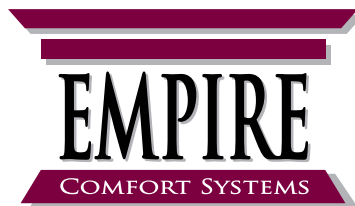
**Figure 13**

14. Replace logs as indicated in log manual. For **Log E (LS30TINF)** or **Log D (LS35TINF)** angle front of log toward right side liner. **Log I** can be positioned with the lower end closer to the left side liner.
15. Reinstall glass door and barrier screen.

## BLACK REFLECTIVE LINER KIT EXPLODED VIEW AND PARTS LIST



| INDEX<br>NUMBER | PART NUMBERS |           | DESCRIPTION               | QUANTITY<br>SUPPLIED |
|-----------------|--------------|-----------|---------------------------|----------------------|
|                 | DVP30CPKR    | DVP35CPKR |                           |                      |
| 1               | 37912        | 38529     | Rear Liner Bracket        | 1                    |
| 2               | 38120        | 38502     | Bottom Liner              | 1                    |
| 3               | 38119        | 38501     | Top Liner (Ceramic Fiber) | 1                    |
| 4               | 38025        | 38486     | Liner Bracket             | 1                    |
| 5               | R12527       | R12530    | Rear Liner (Glass)        | 1                    |
| 6               | R12528       | R12531    | Left Liner (Glass)        | 1                    |
| 7               | R12529       | R12532    | Right Liner (Glass)       | 1                    |
| 8               | 42028        | 42032     | Rear Heat Shield          | 1                    |
| 9               | 42029        | 42033     | Left Heat Shield          | 1                    |
| 10              | 41920        | 41919     | Bracket, Liner-Side       | 2                    |



SINCE 1932

**Empire Comfort Systems Inc.**  
**Belleville, IL**

If you have a general question  
about our products, please e-mail  
us at [info@empirecomfort.com](mailto:info@empirecomfort.com).

If you have a service or repair  
question, please contact your dealer.

**[www.empirecomfort.com](http://www.empirecomfort.com)**