

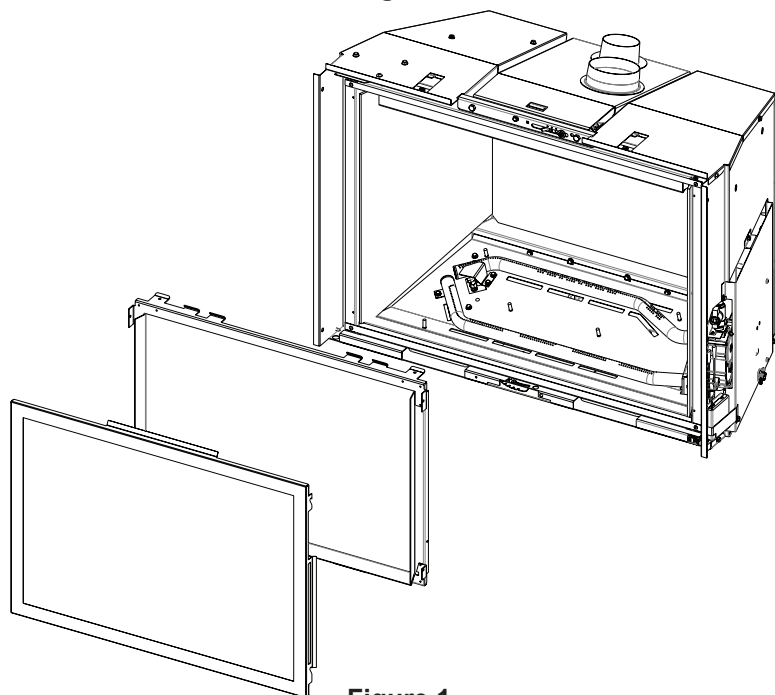
# INSTALLATION INSTRUCTIONS

## DVCT(30,35) GLASS LINER KIT

FOR USE ON: DVCT30 AND DVCT35 DASH-1 UNITS

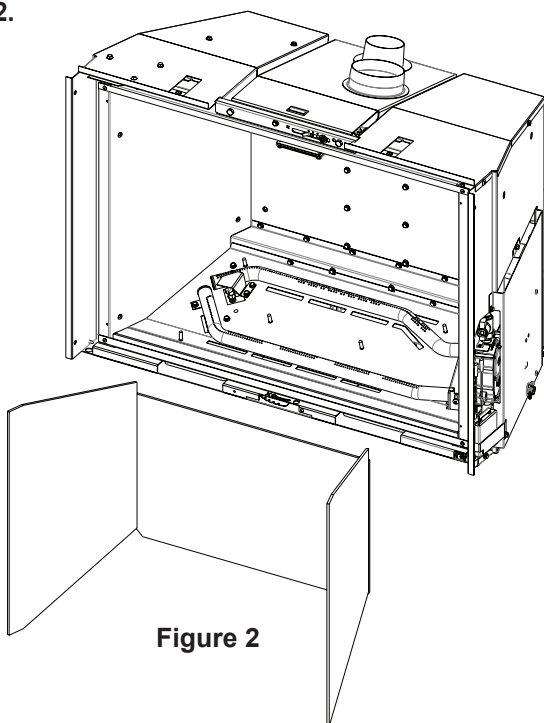
### INSTALLATION

1. Turn off gas and electric to unit.
2. Remove screen, glass door, and logs from unit, see owner's manual. **See Figure 1.**
4. Remove top liner bracket by removed 3 screws. Remove liner top from unit and discard, liner top will not be used. **See Figure 3.**

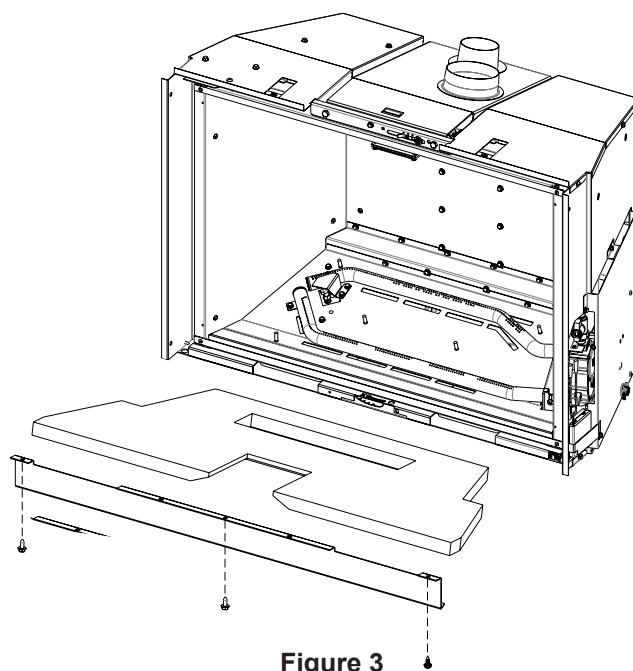


**Figure 1**

3. Remove all 3 pieces of glass liner sides and rear. **See Figure 2.**

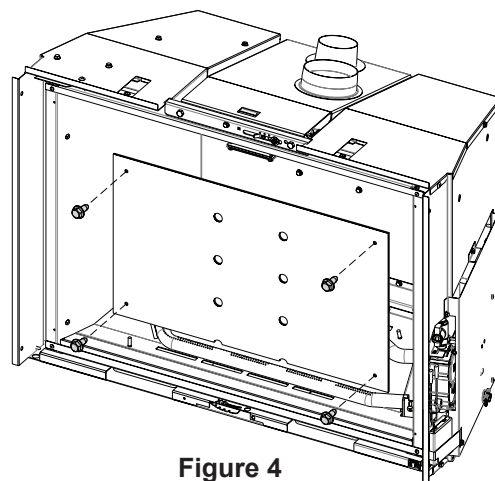


**Figure 2**



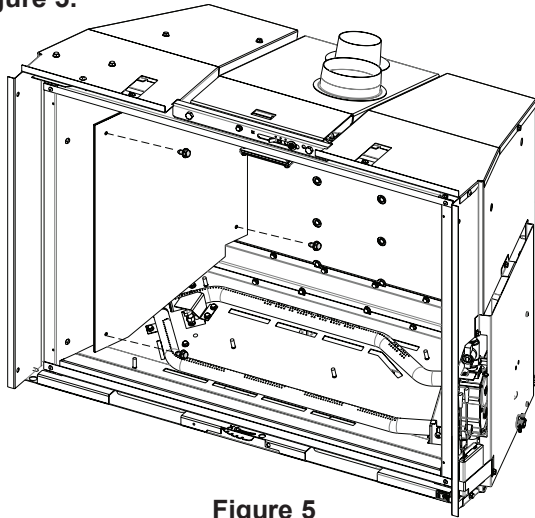
**Figure 3**

5. Place rear heat shield into firebox as shown and align holes on heat shield to screw heads on rear of firebox. Using 4 self-drilling screws, secure rear heat shield to rear of firebox. **See Figure 4.**



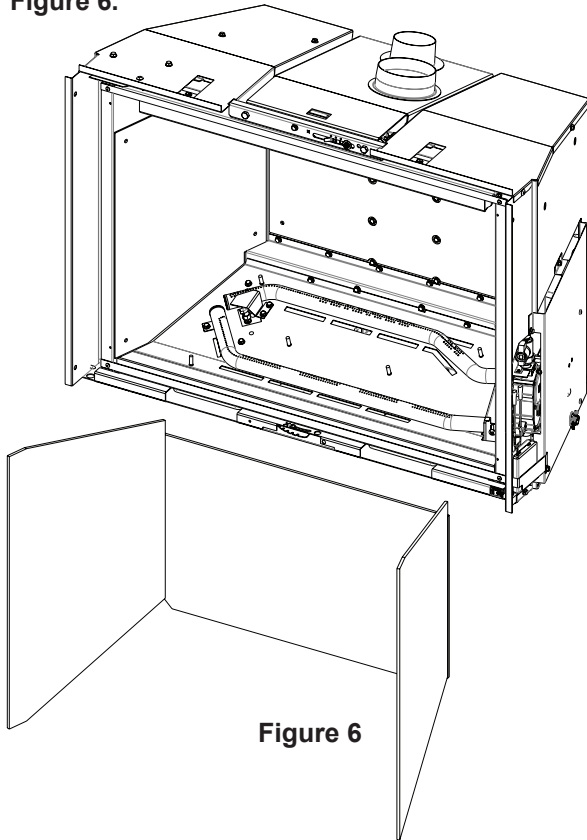
**Figure 4**

6. Place left side heat shield into firebox as shown and push as far back as it can go against rear heat shield and rest on burner base. Using 4 self-drilling screws, secure left side heat shield to left side of firebox. **See Figure 5.**



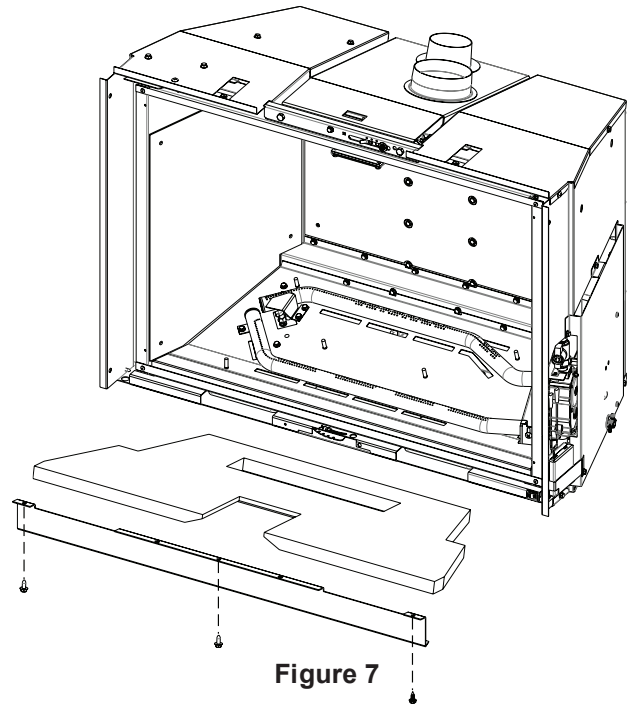
**Figure 5**

7. Replace rear glass liner followed by the 2 sides. **See Figure 6.**



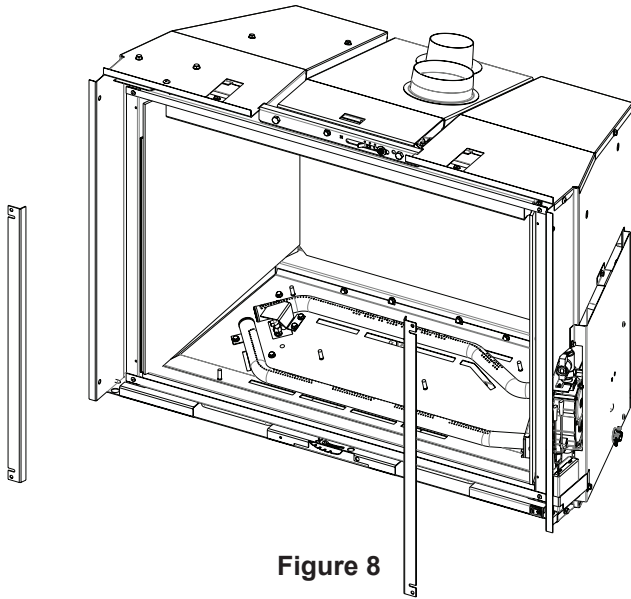
**Figure 6**

8. Secure new liner top to unit using 3 screws and liner top bracket. **See Figure 7.**

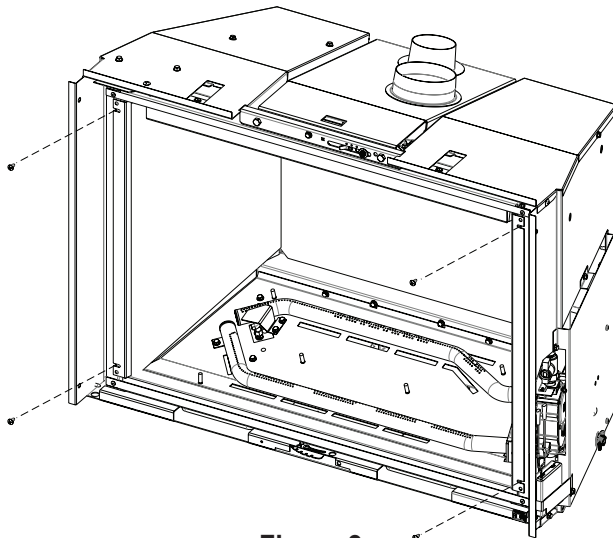


**Figure 7**

9. Locate new side liner brackets and place onto unit as shown below in **Figures 8 and 9**. Using a 1/8" drill bit, add 4 holes to firebox front lip to accept the screws into the open slots of the liner side brackets. Finally secure liner brackets to firebox using 4 black Phillip screws supplied, as shown in **Figure 9**.



**Figure 8**



**Figure 9**

10. Replace logs, embers, glass door, and screen. See owner's manual.
11. Turn on gas and electric back on. The rework has been completed at this time.



SINCE 1932

**Empire Comfort Systems Inc.**  
**Belleville, IL**

If you have a general question  
about our products, please e-mail  
us at [info@empirecomfort.com](mailto:info@empirecomfort.com).

If you have a service or repair  
question, please contact your dealer.

**[www.empirecomfort.com](http://www.empirecomfort.com)**