

INSTALLATION INSTRUCTIONS BLOWER & LIGHT REPLACEMENT KIT

FOR USE ON: DVCT30 AND DVCT35 DASH-1 UNITS

INSTALLATION

1. Turn off gas and electric to unit. Take unit out of the fireplace if applicable.
2. Remove 4 screws and remove outer top, repeat for other side. Set parts aside, they will be re-used. **See Figure 1.**
4. Remove 7 screws and remove outer rear assembly. Discard this assembly, it will not be needed. **See Figure 3.**

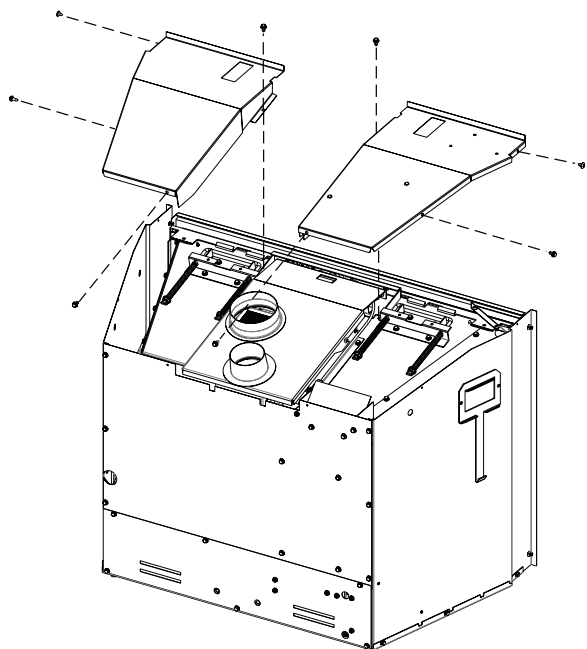

Figure 1

3. Remove 6 screws to blower assembly and disconnect wire harness to blower. Discard blower assembly, it will not be needed. **See Figure 2.**

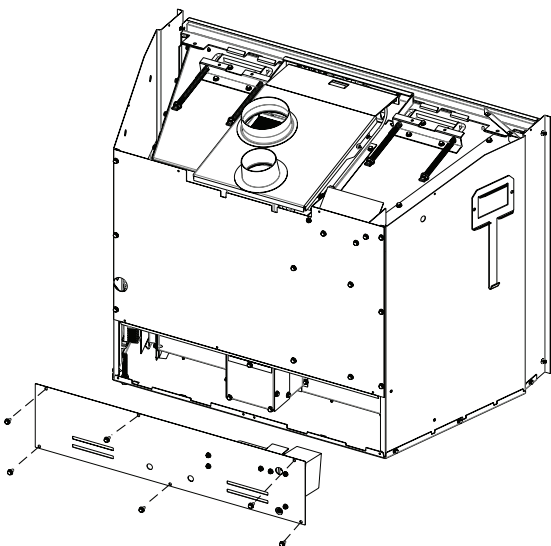

Figure 2

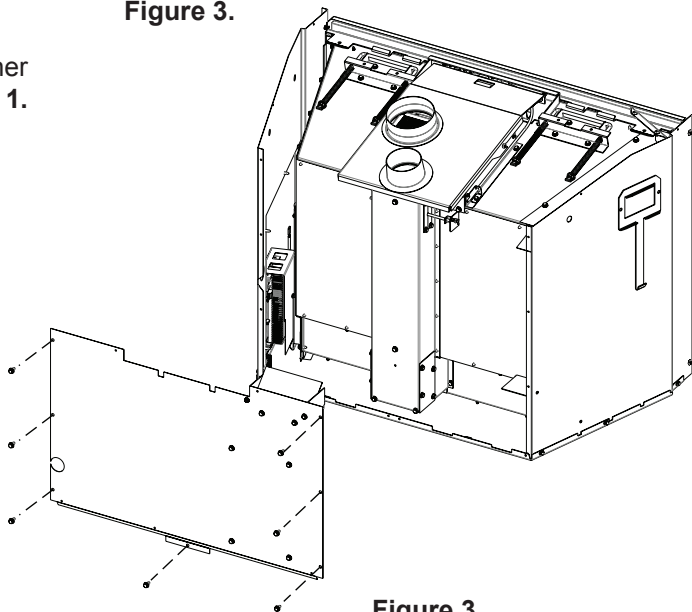

Figure 3

5. Remove 3 screws and remove outer left side. Discard this part, it will not be needed. **See Figure 4.**

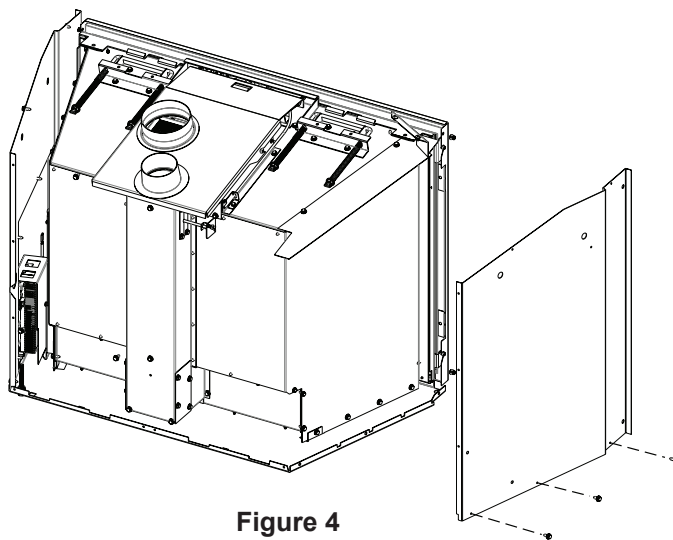

Figure 4

6. Remove 2 bolts holding the slide plate into place if you have not already done so. Set aside, it will be re-used. Also remove wire shield with 1 screw, replace screw and discard shield. Shield will not be needed. **See Figure 5.**

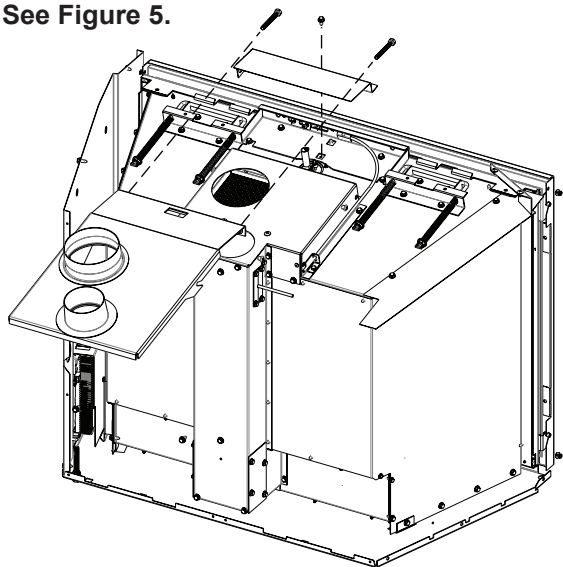

Figure 5

7. If liner is installed, you will need to remove the top bracket held in by 3 screws. Remove top liner and set these items aside, they will be re-used. **See Figure 6.**

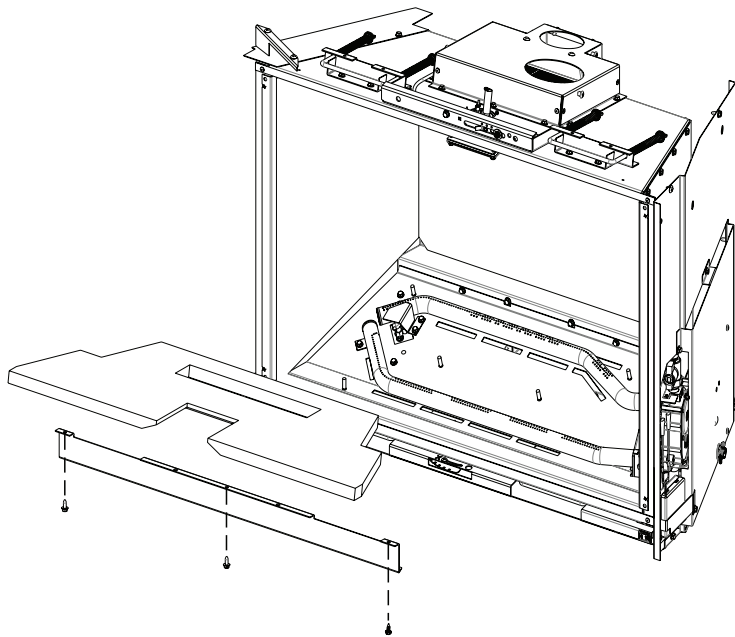

Figure 6

8. Remove 5 screws holding right shield and pull right shield aside, be careful since it has several wire harnesses still attached to unit. **See Figure 7.**

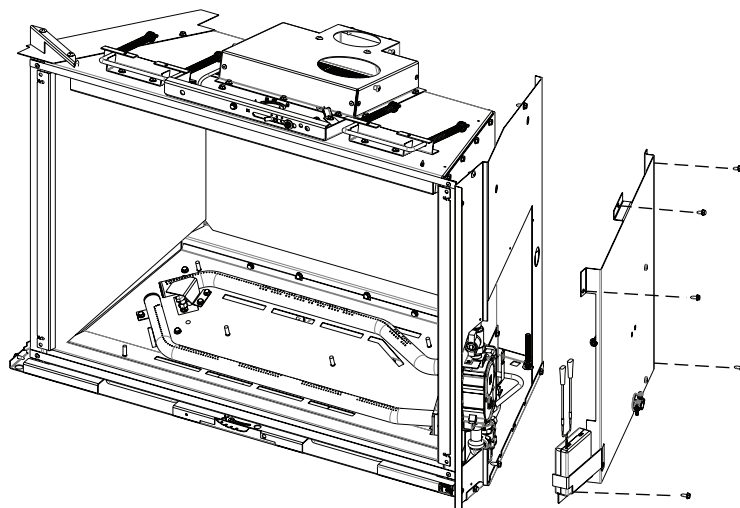

Figure 7

9. Remove 2 wires shown in **Figure 8.**

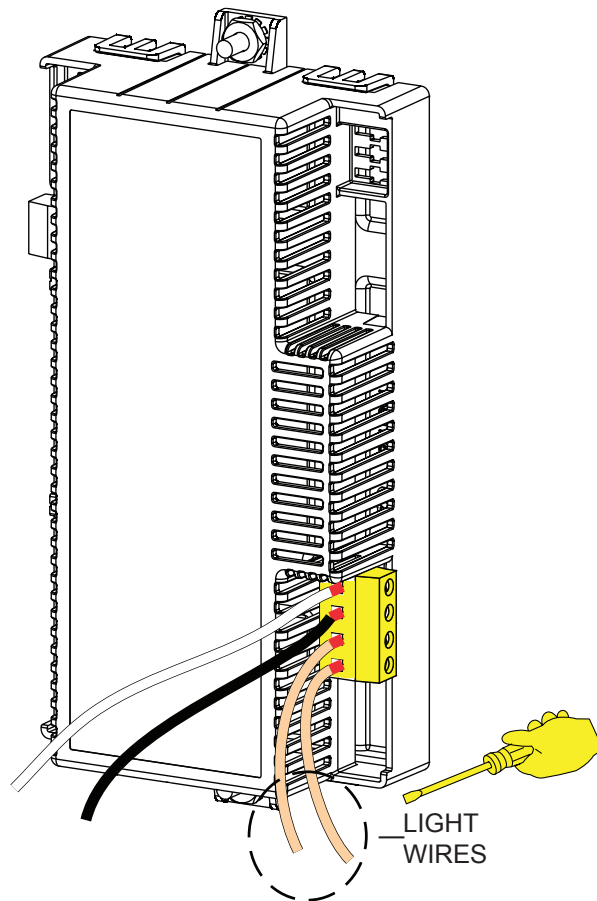

Figure 8

10. Remove 4 screws, bezel, gasket, and glass from light assembly. Remove 4 screws holding the light assembly to the firebox top and carefully remove it from the unit. Discard all of these items, they will not be needed. **See Figure 9.**

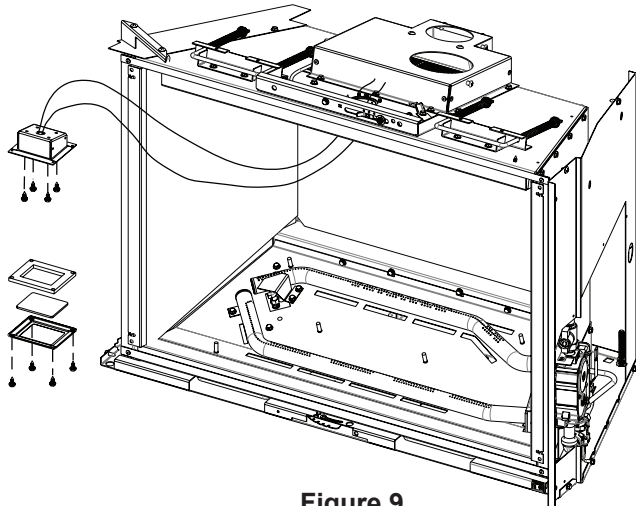

Figure 9

11. Re-install the new light assembly in reverse order of step 10. Use **Figure 9** as reference. Route wires to control module and attach. **See Figure 8.**
12. Re-attach right side panel in step 8 with 5 screws.
13. Re-attach slide plate with 2 bolts, you may choose to do this step at a later time. This will depend on your install. **See Figure 10.**

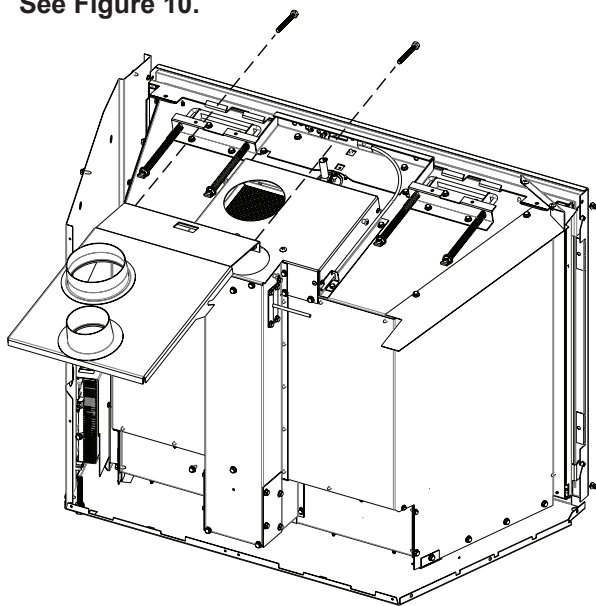

Figure 10

14. Install new left side assembly using 3 screws. **See Figure 11.**

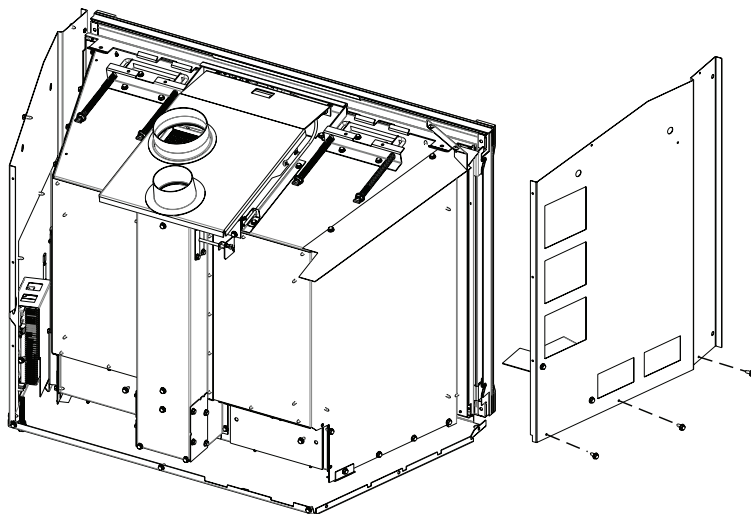

Figure 11

15. Line up the 2 screws coming out of the rear of the firebox with heat shield assembly, using 2 self drilling screws, secure heat shield as shown in **Figure 12.**

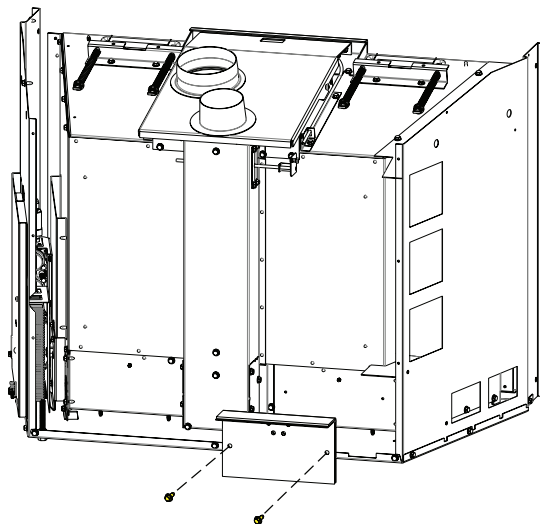

Figure 12

16. Install new rear assembly using 7 screws. **See Figure 13.**

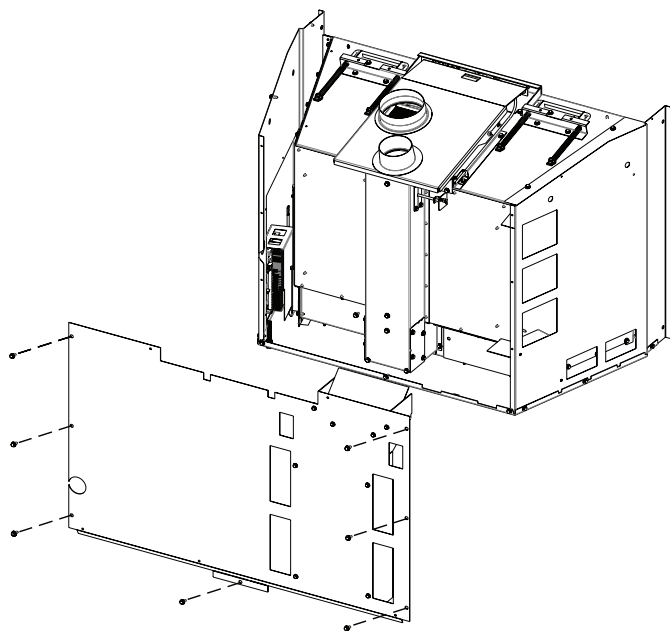

Figure 13

17. Re-attach outer tops to unit, be careful with light assembly wire harness, do not pinch wires under top, wires should run between top and center combustion box. **See Figure 14.**

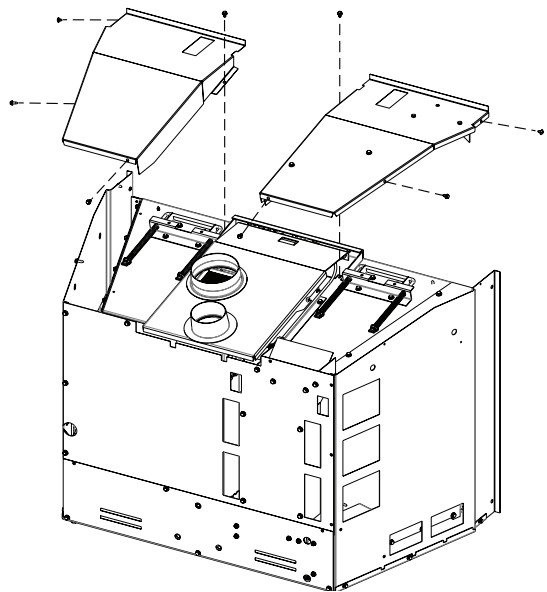

Figure 14

18. Re-attach blower wire harness to blower. Attach new blower assembly to unit using 6 screws, be careful not to pinch wires between metal. **See Figure 15.**

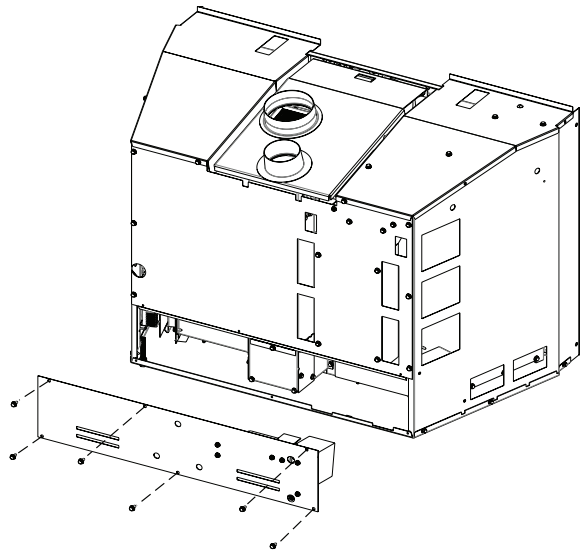

Figure 15

19. If liner was installed before this process, you will need to replace the liner top in reverse order of step 7.

20. Return unit into place and you may now turn gas and electric back on. It is recommended to check for leaks at this time. The rework has been completed at this time.



SINCE 1932

www.empirecomfort.com

Empire Comfort Systems Inc.
Belleville, IL

If you have a general question
about our products, please e-mail
us at info@empirecomfort.com.

If you have a service or repair
question, please contact your dealer.